

## PM 1207

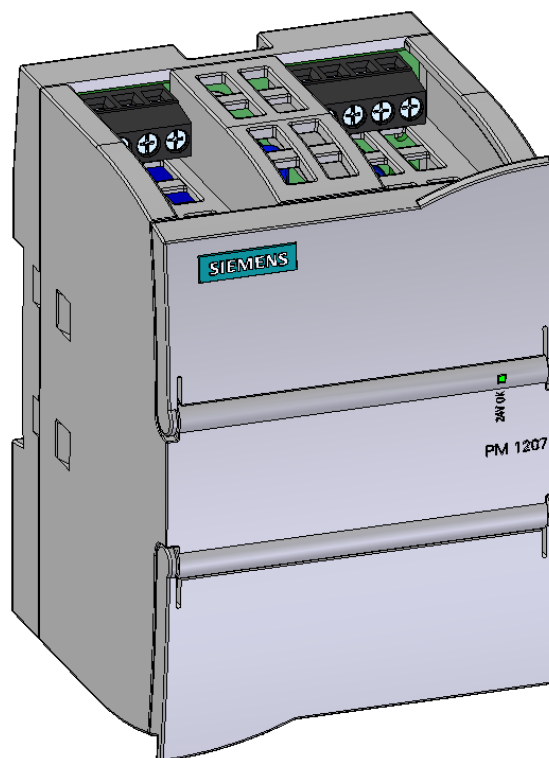

**Betriebsanleitung**  
Operating instructions  
Instructions d'utilisation  
Istruzione per l'uso  
Instrucciones de uso

Nr.: C98130-A7569-A1-04-6419



### **Hinweis**

Diese Betriebsanleitung enthält aus Gründen der Übersichtlichkeit nicht sämtliche Detailinformationen zu allen Typen des Produkts und kann auch nicht jeden denkbaren Fall der Aufstellung, des Betriebes oder der Instandhaltung berücksichtigen. Weiterführende Hinweise erhalten Sie über die örtliche Siemens-Niederlassung bzw. über die Homepage <http://www.automation.siemens.com/sitop>. Technische Änderungen jederzeit vorbehalten. In Zweifelsfällen gilt der deutsche Text.

### **Note**

These instructions cannot claim to cover all details of possible equipment variations, nor in particular can they provide for every possible example of installation, operation or maintenance. Further information is obtainable from your local Siemens office or visit our homepage <http://www.automation.siemens.com/sitop>. Subject to change without prior notice. The German text applies in cases of doubt.

### **Note**

Pour des raisons de clarté, cette notice ne contient pas toutes les informations de détail relatives à tous les types du produit et ne peut pas non plus tenir compte de tous les cas d'installation, d'exploitation et de maintenance imaginables. Pour de plus amples informations, veuillez-vous adresser à votre agence Siemens ou consultez notre site <http://www.automation.siemens.com/sitop>. Sous réserve de modifications techniques. En cas de divergences, le texte allemand fait foi.

### **Nota**

Ai fini della chiarezza le presenti istruzioni di servizio non contengono tutte le informazioni dettagliate su tutti i tipi del prodotto e non possono nemmeno trattare tutti i casi di installazione, di esercizio o di manutenzione. Per ulteriori informazioni rivolgersi alla filiale Siemens di zona o consultare la homepage <http://www.automation.siemens.com/sitop>. Ci riserviamo eventuali modifiche tecniche. In caso di differenze o problemi è valido il testo tedesco.

### **Nota**

Por razones de claridad, estas instrucciones no contienen todas las informaciones detalladas relativas a todos los tipos del producto ni pueden considerar todos los casos de instalación, de operación y de mantenimiento imaginables. Para más información, contacte con la sucursal local de Siemens o visite la Web <http://www.automation.siemens.com/sitop>. Sujeto a cambios técnicos sin previo aviso. En casa de duda, prevalece el texto alemán.

**Warnings**

The PM 1207 is a stabilized power supply designed for operation on single-phase AC systems. The unit must be installed in compliance with the relevant national and/or regional regulations. The supply voltage connection must be made in accordance with standards IEC 60364 and EN 50178. A protective device (fuse) and disconnector for isolating the power supply must be provided. This equipment cannot be guaranteed to operate reliably and without faults unless it has been correctly transported and properly stored, assembled and installed.

**Electric shock hazard !**

Certain components in electrical equipment inevitably carry hazardous voltage when the equipment is in operation. Failure to handle the equipment in accordance with prescribed procedures can thus result in severe or fatal injury and/or serious damage to property. All personnel who work on or in the vicinity of the device must be properly trained and qualified.

**Caution !**

Components susceptible to ElectroStatic Discharge (ESD). The unit must never be opened by personnel who are not properly qualified!

**Installation and assembly:**

The PM 1207 must be installed and wired up by a properly qualified expert who is familiar with and adheres to general state-of-the-art engineering practice as well as the relevant regulations and standards.

The device must not be attached to IT systems.



**Danger** Before any installation or maintenance work is undertaken, the master switch must be opened and protected against reclosure. A suitable disconnector for isolating the unit from the supply circuit must be provided for maintenance procedures. The PM 1207 is a built-in device and must therefore be mounted in a distribution box or control cabinet.

The unit can be snapped onto DIN rails in accordance with EN 60175-35x7.5/15. To install (Fig. A), suspend the unit on the rail ③ by lugs ① and press until the mounting slide ② engages (see page 7). If the unit does not snap easily onto the rail, loosen slide ② slightly as described under Dismounting (Fig. B). To dismount the unit from the rail, use a screwdriver to undo the mounting slide ② in the direction of the arrow and dismount the unit. The unit is also designed for wall mounting. To wall-mount the unit, push the two mounting slides on the rear in the arrow directions illustrated in Fig. C.

Use a screwdriver with a 3mm blade width (tightening torque 0.45 Nm) to wire up the unit. You can use copper cables (approved for 65/75 °C) with a cross section of up to 1 x 2.5 mm<sup>2</sup> (with/without wire end ferrule) or 2 x 1.5 mm<sup>2</sup> (without wire end ferrule). Separate routing of the incoming mains cable and outgoing cables is recommended.

To ensure that the unit is properly cooled, it must be mounted vertically with the input and output terminals at the top. A minimum clearance of 2 cm must be left above and below the unit to allow natural convection.

It is permissible to connect two identical units in parallel to boost output.

**Technical data:** Unless otherwise specified, all technical data apply for an input voltage of 230 V AC and an ambient temperature of +25 °C. Subject to technical changes without prior notice.

**Type:** 24V/2.5A  
**Order number:** 6EP1332-1SH71

**Input data:**

Rated input voltage $U_{e \text{ rated}}$ :	120/230 V AC (automatic range switchover)
Working voltage range:	85...132/176...264 V AC
Rated frequency range:	47...63 Hz
Mains buffering:	> 20 ms at $U_e = 93/187$ V and rated load
Rated input current $I_{e \text{ rated}}$ :	1.20/0.67 A
Protection in main supply conductor:	Recommended: Miniature circuit breaker (IEC 898) 16 A characteristic B or 10 A characteristic C

**Output data:**

Rated output voltage $U_a \text{ rated}$ :	24 V DC +/-1%
Residual ripple/spikes:	< 150/240 mV <sub>pp</sub>
Starting delay:	Typically < 5 seconds
Output overvoltage protection:	< 33 V
Rated output current $I_a \text{ rated}$ :	2.5 A
Activation point current limiting:	2.65 A +/-5%
Maximum output current:	2.8 A
Efficiency under rated load:	> 83 %

**Ambient conditions:**

Temperature during storage / transport:	-25 °C...+85 °C
Ambient temperature in operation:	0 °C...+60 °C
Degree of protection:	IP 20 to EN 60529
Humidity rating:	Climate class 3K3 to EN 60721, relative humidity 5...95 %, without condensation
EMC interference emission:	EN 61000-6-3, EN 55022 B
EMC interference immunity:	EN 61000-6-2, EN 61000-4-2/-3/-4/-5/-6/-11

**Safety:**

Protection class:	Class I (EN 60950)
Galvanic isolation primary/secondary:	SELV acc. to EN 60950 and EN 50178, transformer acc. to EN 61558-2-17

**Certificates:**

CE	CE conformance in accordance with 2004/108 EEC and 2006/95 EEC
UL	cULus-Listed (UL 508, CSA C22.2 No.142) File E197259
CB Scheme	IEC 60950-1

**Disposal information:**

The packaging and supplementary packing components are recyclable and must always be disposed of at an appropriate recycling center.

**Maßbild/ Montagehinweis**  
**Dimensional drawing/ Installation note**  
**Dimensions / montage**  
**Disegno Quotato / Indicazioni di montaggio**  
**Dimensiones / Indicaciones de montaje**

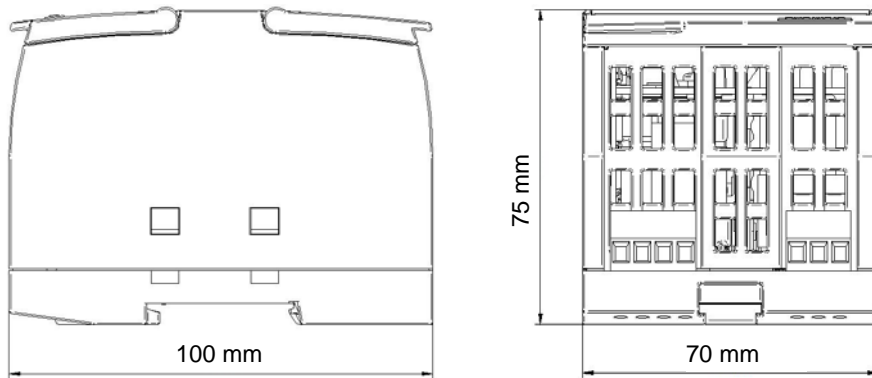

Fig. A:

Fig. B:

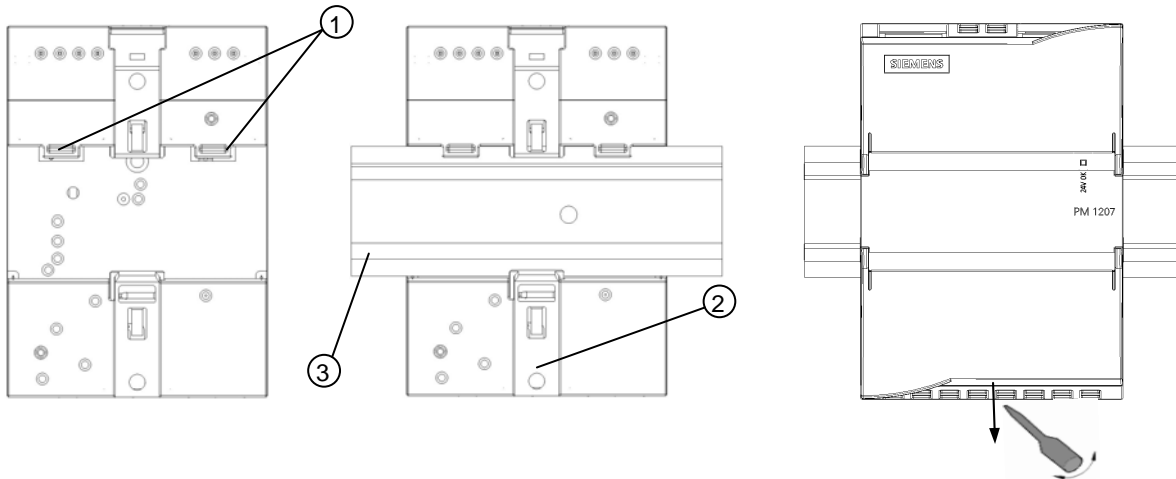
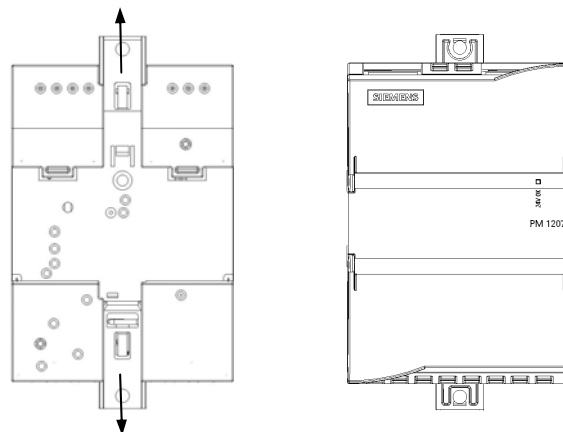

Fig. C:



Gewicht ca. / Weight approx. / Poids ca. / Peso ca. / Peso aprox. 0,3 kg (0,66 lb)

Issued by: SIMEA IA SE  
 Siemensstraße 90-92  
 A-1210 Vienna

© 2009 Siemens AG Austria. All rights reserved.  
 Availability and technical specifications are  
 subject to change without prior notice.