

Product information

Entries

Technical / CAx data

Successor product

Technical Data CAx data



SITOP PSE200U 3 A SELECTIVITY
MODULE 4-CHANNEL INPUT: 24 V
DC; OUTPUT: 24 V DC/3 A PER EACH
CHANNEL OUTPUT CURRENT
ADJUSTABLE 0.5-3

Technical specifications

Product	SITOP PSE200U
Power supply, type	Selectivity module, 4 x 3 A
Input	
Input	Controlled DC voltage
Supply voltage / for DC / rated value	24 V
Input voltage	
• at DC	22...30 V
Overvoltage resistance	35 V
Input current / at nominal level of the input voltage 24 V / nominal value	12 A
Output	
Output	controlled DC voltage
Output voltage	V _{in} - approx. 0.2 V
Total tolerance	In accordance with the supplying input voltage
Number of channels / secondary side	4
Output current / at 60 °C / per channel / rated value	3 A
Adjustable output current	0.5...3 A
Output voltage setting	via potentiometer
Product feature / Bridging of channels	No
Type of channel connection	Simultaneous connection of all channels after power up of the supply voltage > 20 V, delay time of 25 ms, 100 ms or adjustable "load optimised" via DIP switch for sequential connection
Efficiency	

Efficiency at V_{out} rated, I_{out} rated, approx.	97 %
Power loss at V_{out} rated, I_{out} rated, approx.	9 W
Switch-off characteristic per channel	
Overcurrent switch-off	$I_{out} = 1.0 \dots 1.3 \times$ set value, switch-off after approx. 5 s
Current limitation	$I_{out} = 1.3 \times$ set value, switch-off not before typ. 100 ms
Immediate switch-off	$I_{out} >$ set value and $V_{in} < 20$ V, switch-off after approx. 0.5 ms
Reset	Using keys for each channel
Remote reset	Non-isolated 24 V input (signal level "high" at > 15 V)
Protection and monitoring	
Device/Line protection	5 A internal fuse per channel (not accessible)
Status display	Three-color LED per channel: green LED for "Output switched through"; yellow LED for "Output switched off manually"; red LED for "Output switched off due to overcurrent"
Signaling	Common signal contact (changeover contact, rating 0.1 A/24 V DC)
Safety	
Standard / for security	according to EN 60950-1 and EN 50178
Protection class	Class III
CE mark	Yes
Degree of protection (EN 60529)	IP20
UL/cUL (CSA) approval	UL-Recognized (UL 2367), File E328600; cURus (UL 508, CSA C22.2 No. 107.1), File E197259
Standard / for explosion protection	ATEX (EN 60079-0, -15)
Explosion protection	ATEX (EX) II 3G Ex nAC II T4; cCSAus (CSA E60079, UL 60079), Class I, Div. 2, Group ABCD, T4
EMC	
Emitted interference	EN 55022 Class B
Noise immunity	EN 61000-6-2
Operating data	
Ambient temperature	
• in operation	0...60 °C
• Note	with natural convection
Ambient temperature	
• on transport	-40...+85 °C
• in storage	-40...+85 °C
Humidity class according to EN 60721	Climate class 3K3, no condensation
Mechanics	
Connection technology	screw-type terminals
Design of the electrical connection	
• at the input	+24 V: 2 screw terminals for 0.5 ... 10 mm ² ; 0 V: 2 screw terminals for 0.5 ..

- secondary side
- for signaling contact
- for auxiliary contact

Output 1 ... 4: 1 screw terminal each for 0.5 ... 4 mm²

3 screw terminals for 0.5 ... 4 mm²

Remote reset: 1 screw terminal for 0.5 ... 4 mm²

Width / of the housing	72 mm
Height / of the housing	80 mm
Depth / of the housing	72 mm
Installation width	72 mm
Mounting height	180 mm
Net weight	0.2 kg
Installation	Snaps onto DIN rail EN 60715 35x7.5/15
Mechanical accessories	Device identification label 20 mm x 7 mm, pastel-turquoise 3RT1900-1SB20
Other information	Specifications at rated input voltage and ambient temperature +25 °C (unless otherwise specified)

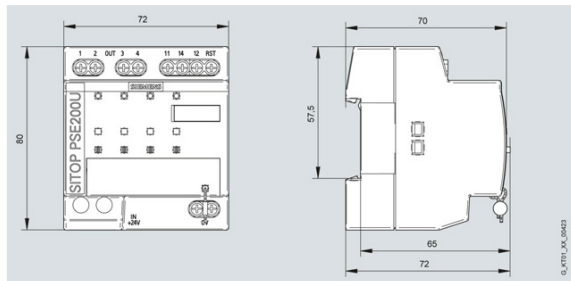

letzte Änderung:

Mar 12, 2012

This entry is available in the following languages:

→ German → French → Italian → Spanish → Chinese

→ Copy link

→ Send to a friend

→ Print